

DIMENSION	TOLERANCE
≤10	±0.3
10~100	±0.5
≥100	±0.8

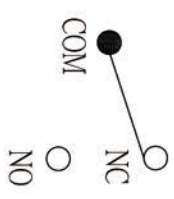

SW CIRCUIT

RED

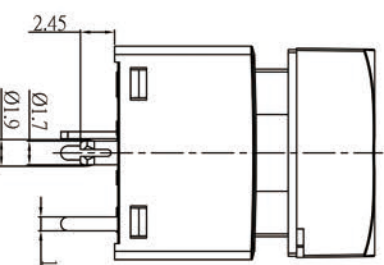
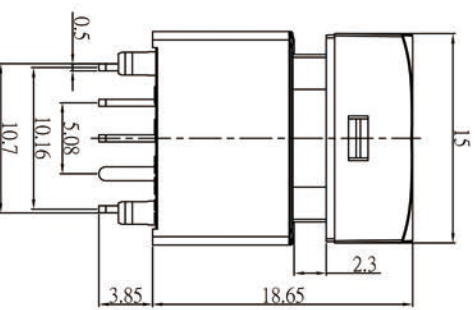
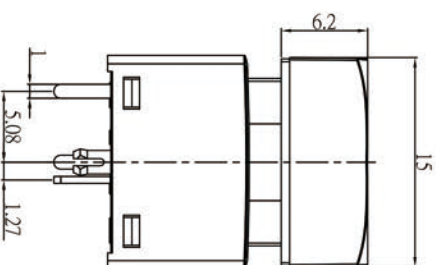
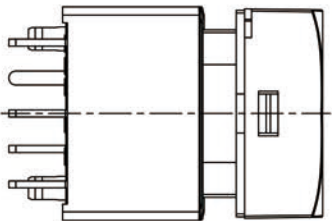
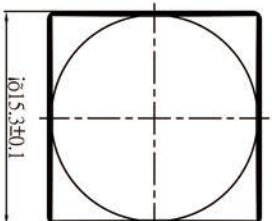

LED CIRCUIT

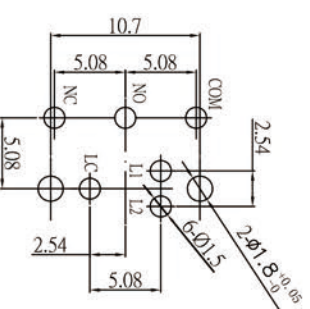

PCB LAYOUT  
[reference drawing]

1. RATING : 28 V DC , 0.4A .
2. CONTACT RESISTANCE : 100 mΩ , MAX .
3. INSULATION RESISTANCE : DC 500 V / 100 MΩ , MIN .
4. WITHSTAND VOLTAGE : AC 500 V / 1 MINUTE .
5. OPERATING TEMPERATURE : -25 °C ~ 70 °C .
6. OPERATING FORCE : 200±100 gf .
7. LIFE CYCLE : 200,000 CYCLES .

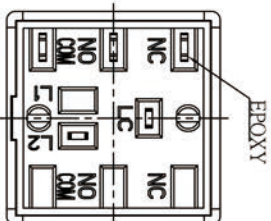

VER	DATE	APPROVAL	CONFIRM	DESIGN	UNIT	SCALE	ANGLE TER	VIEW	MODE
V0	2015/5/25	JOHNSON	ALEN	MIKE	mm	1 : 1	± 3°		PUSH WITH LED SWITCH
ENGINEERING RECORD DESCRIPTION					PLB-NIPNR-ATW				
ORIGINAL DESIGN					WWW.SZLAKEVIEW.COM				
ENGINEERING RECORD DESCRIPTION					ELECTRONICS CO., LTD				
					Tel: (86)755-2942472/29424733				