

DIMENSION	TOLERANCE
≤10	± 0.3
10~100	± 0.5
≥100	± 0.8

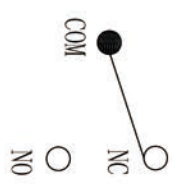

SW CIRCUIT

BLUE

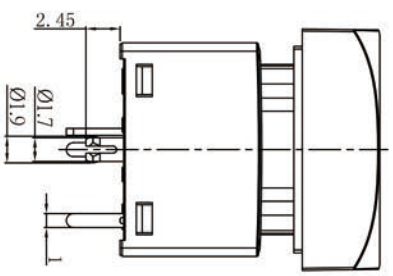
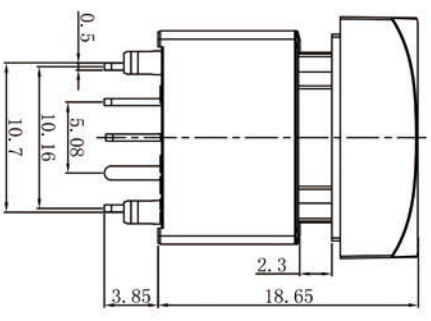
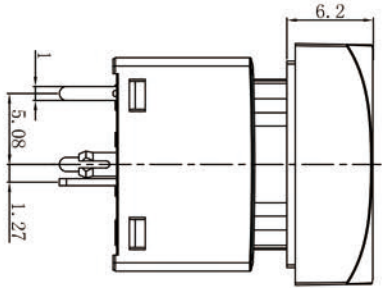
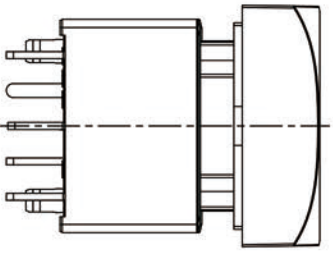
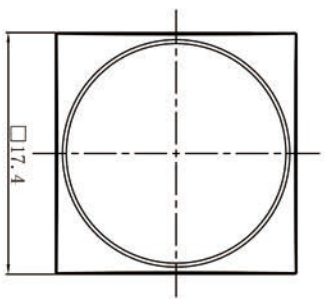

LED CIRCUIT

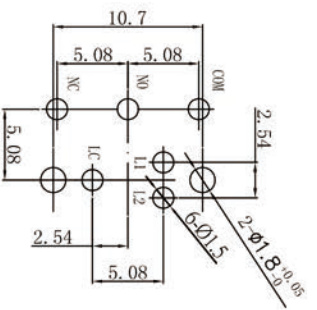

PCB LAYOUT
[reference drawing]

1. RATING : 28 V DC , 0.4A .
2. CONTACT RESISTANCE : 100 mΩ MAX .
3. INSULATION RESISTANCE : DC 500 V / 100 MΩ MIN .
4. WITHSTAND VOLTAGE : AC 500 V / 1 MINUTE.
5. OPERATING TEMPERATURE : -25°C ~ 70°C .
6. OPERATING FORCE : 200 ± 100 gf .
7. LIFE CYCLE: 200,000 CYCLES .

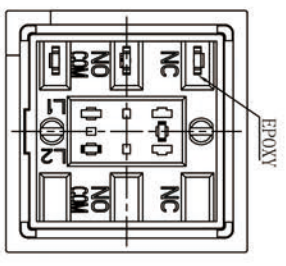

VER	DATE	APPROVAL	CONFIRM	DESIGN	ORIGINAL DESIGN	ENGINEERING RECORD DESCRIPTION	UNIT	SCALE	ANGLE TER	VIEW	MODE
00	2015/5/25	JOHNSON	ALEN	MINE			mm	1 : 1	± 3°		
						PLB-NIPNB-CTW					
							WWW.SZLAKEVIEW.COM ELECTRONICS CO., LTD		Tel: (86)755-29424722/29424733		