

PIN TYPE	
1	SW Terminal 1
2	SW Terminal 2
VDD	V _{DD} [Power]
DIN	DI [Data In]
DOUT	DO [Data Out]
GND	GND [Ground]

DIMENSION	TOLERANCE
≤10	± 0.3
10~100	± 0.5
≥100	± 0.8

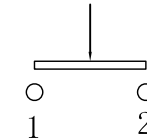

SW CIRCUIT

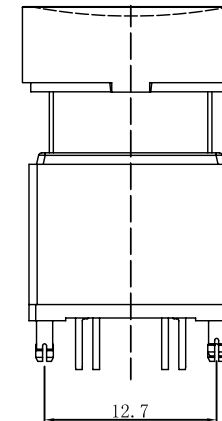
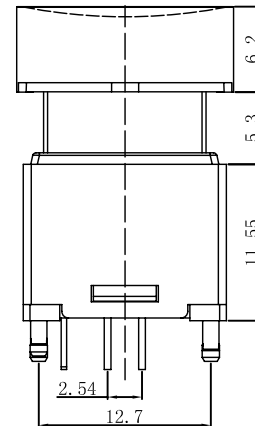
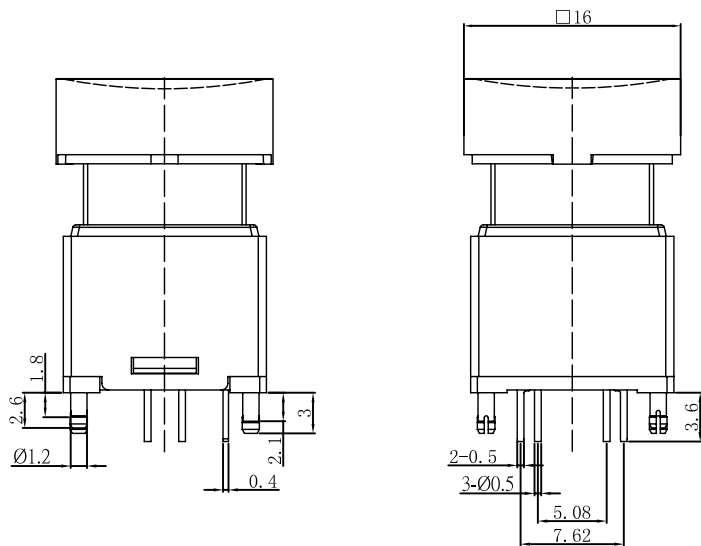

"IC CONTROL"
"RGB LED"

LED TYPE

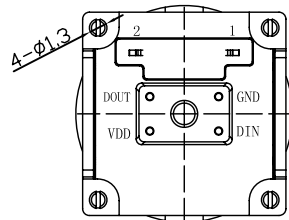

1. RATING : 12 V DC , 0.1A .
2. CONTACT RESISTANCE : 200 mΩ MAX . (Initial)
3. INSULATION RESISTANCE : 100 MΩ MIN (DC 250V) .
4. WITHSTAND VOLTAGE : AC 250 V / 1 MINUTE.
5. OPERATING TEMPERATURE : -25°C ~ 70°C .
6. OPERATING FORCE : 250±100 gf .
7. FULL TRAVEL : 4.5±0.3 .
8. LIFE CYCLE: 2,000,000 CYCLES .

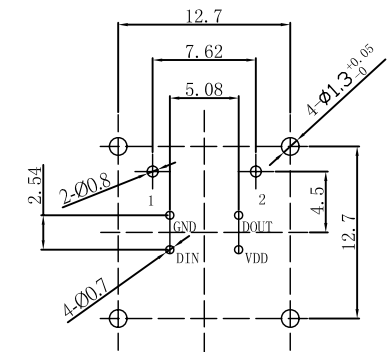

PCB LAYOUT

VO	DATE	APPROVAL	CONFIRM	DESIGN	ENGINEERING RECORD DESCRIPTION	UNIT	SCALE	ANGLE TER	VIEW	MODE	
2015/7/25	JOHNSON	ALEN	MIKE	ORIGINAL DESIGN		mm	1 : 1	± 3°		PUSH WITH LED SWITCH	WWW.SZLAKEVIEW.COM ELECTRONICS CO., LTD
VER	DATE	APPROVAL	CONFIRM	DESIGN	ENGINEERING RECORD DESCRIPTION	PLC-N1TFN-RATW-AI				Tel:	(86) 755-29424722/29424733