

DIMENSION	TOLERANCE
≤10	± 0.3
10~100	± 0.5
≥100	± 0.8

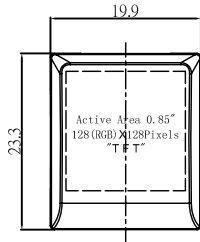

1	SWITCH Terminal
2	SWITCH Terminal
PIN 3	RES [Power Reset for Controller and Driver]
PIN 4	SDIN [Serial Data Input Signal]
PIN 5	SCLK [Serial Clock Input Signal]
PIN 6	CS# [Chip Select]
PIN 7	D/C# [Data/Command Control]
PIN 8	VCC[3.3V] [Power Supply for Core Logic Circuit]
PIN 9	LEDA [LED Anode]
PIN 10	VSS [Ground of Logic Circuit]

Terminal's Configuration

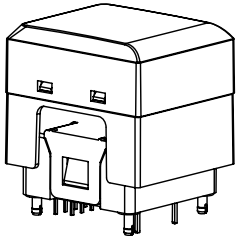
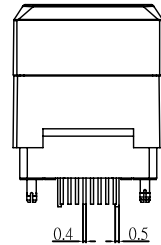
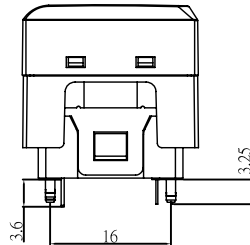
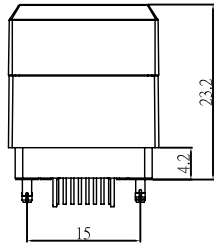
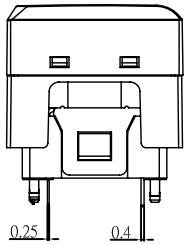

1. SWITCH (1->2) RATING : 12 V DC , 0.1A MAX.
2. CONTACT RESISTANCE : 200 mΩ MAX .(Initial)
3. INSULATION RESISTANCE : 100 MΩ MIN(DC 250V) .
4. WITHSTAND VOLTAGE : AC 125 V / 1 MINUTE.
5. OPERATING TEMPERATURE : -25°C ~ 70°C .
6. OPERATING FORCE : 180±50 gf .
7. FULL TRAVEL : 3.2±0.3 .
8. LIFE CYCLE: 2,000,000 CYCLES .
9. 128(horizontal)X128(vertical) Pixel FORMAT
10. PIN3~PIN10 MUST BE CHECK THE " TFT SPEC"

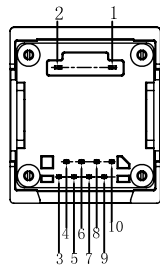
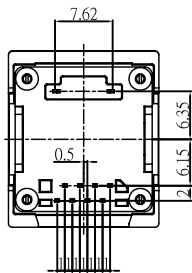

Terminal's VIEW

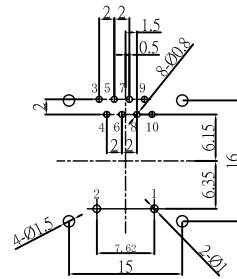

P. C. B. LAYOUT

"128X128"
"LCD-TFT"
[RGB]

PIXEL FORMAT

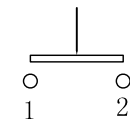

SW CIRCUIT

UNIT	SCALE	ANGLE TER	VIEW	MODE	
mm	1 : 1	± 3°		PUSH WITH OLED SWITCH	
DSP2-N1NFD-AKTN					Tel: (86)755-29424722/29424733
VO	2022/3/10	JOHNSON	ALEN	MIKE	ORIGINAL DESIGN
VER	DATE	APPROVAL	CONFIRM	DESIGN	ENGINEERING RECORD DESCRIPTION